

40" INDUSTRIAL STYLE DUAL FUEL RANGE

Genesi series - GQY10SFF-4T



ALSO AVAILABLE IN



nero BA



antracite AN



ametista AA



celeste CE



bordeaux BR



crema CR



nuvola NA



sabbia SA

FEATURES AND BENEFITS

- 6 wide cooking zones to prepare easily the best family meal
- Combi-Steam to bake as you've always cooked, in shorter time, with less energy consumption, with better results
- Dedicated pizza/bake oven with stone bottom. The reduced height of the oven places your pizza very close to the heating element. This way the complete power of the element is transmitted to the food giving a raising power from the top for the perfect Italian style pizza
- Removable, dishwasher safe, s.steel oven liners
- Full extension telescopic rack rails for easy access to the oven cavity
- Soft closing hinges softly guide the door shut so the oven door never slams

MAIN OVEN PERFORMANCE

BAKE/BROIL ELEMENT WATTS	850 + 1900 W
CONVECTION ELEMENT WATTS	2100 W
LOWER ELEMENT WATTS	1200 W
OVEN VOLUME	2.5 cubic feet

SIDE OVEN PERFORMANCE

BAKE/BROIL ELEMENT WATTS	1200 + 500 W
LOWER ELEMENT WATTS	900 W
OVEN VOLUME	1.4 cubic feet

UPPER OVEN PERFORMANCE

BAKE/BROIL ELEMENT WATTS	850 + 1900 W
LOWER ELEMENT WATTS	1200 W
OVEN VOLUME	1,2 cubic feet

GENERAL PROPERTIES

OVEN FUNCTIONS	defrost, static, upper element, static steam, grill, ventilated grill, fan steam, convection, fast heating, proof
TYPE OF GRATE	enameled cast iron
KNOB/HANDLE MATERIAL	metal
INTERIOR LIGHT	2+2+1 (halogen)
KITCHEN TIMER	no
SEALED BURNERS	yes

COOK TOP PERFORMANCE

TOTAL COOKING ZONES	6 (4 burners + dual frytop)
TOTAL COOK TOP (NG/LP) BTU	36700 / 28700
SIMMER (NG/LP) BTU	4200 / 3000
SEMI-RAPID (NG/LP) BTU	7500 / 5600
RAPID (NG/LP) BTU	11500 / 9500
WOK (NG/LP) BTU	13500 / 10600

TECHNICAL DETAILS

CIRCUIT BRAKER	40 A
VOLTS	120 / 240 V
FREQUENCY	60 Hz
POWER CORD LENGHT	46" (included)
PLUG TYPE	NEMA 50-14P - 4 prong
ENERGY SOURCE	mixed electric / gas
GAS TYPE	natural gas (5" wc)
ALTERNATIVE GAS TYPE	lp (10" wc) - LP kit included

DIMENSIONS & WEIGHT

OVERALL DIMENSIONS	W= 39 5/16" (100cm) H= 35 7/16" (90cm) D= 24 9/16" (62cm)
ADJUSTABLE RANGE HEIGHT	35 7/16" (90cm) min 36 7/32" (92cm) max
OVERALL OVEN INTERIOR SIZE	W= 18 19/64" (46,5cm) H= 13 25/32" (35cm) D= 16 59/64 (43cm)
OVERALL OVEN INTERIOR SIZE (side oven)	W= 10 15/64" (26cm) H= 13 25/32" (35cm) D= 16 59/64 (43cm)
NET WEIGHT	269lbs (122kg)
CUTOUT REQUIREMENTS	

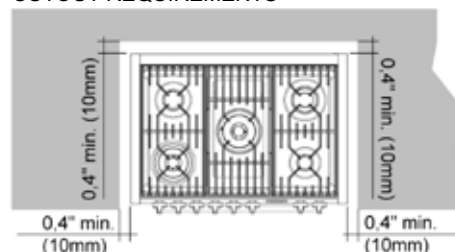

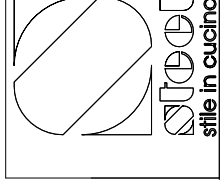
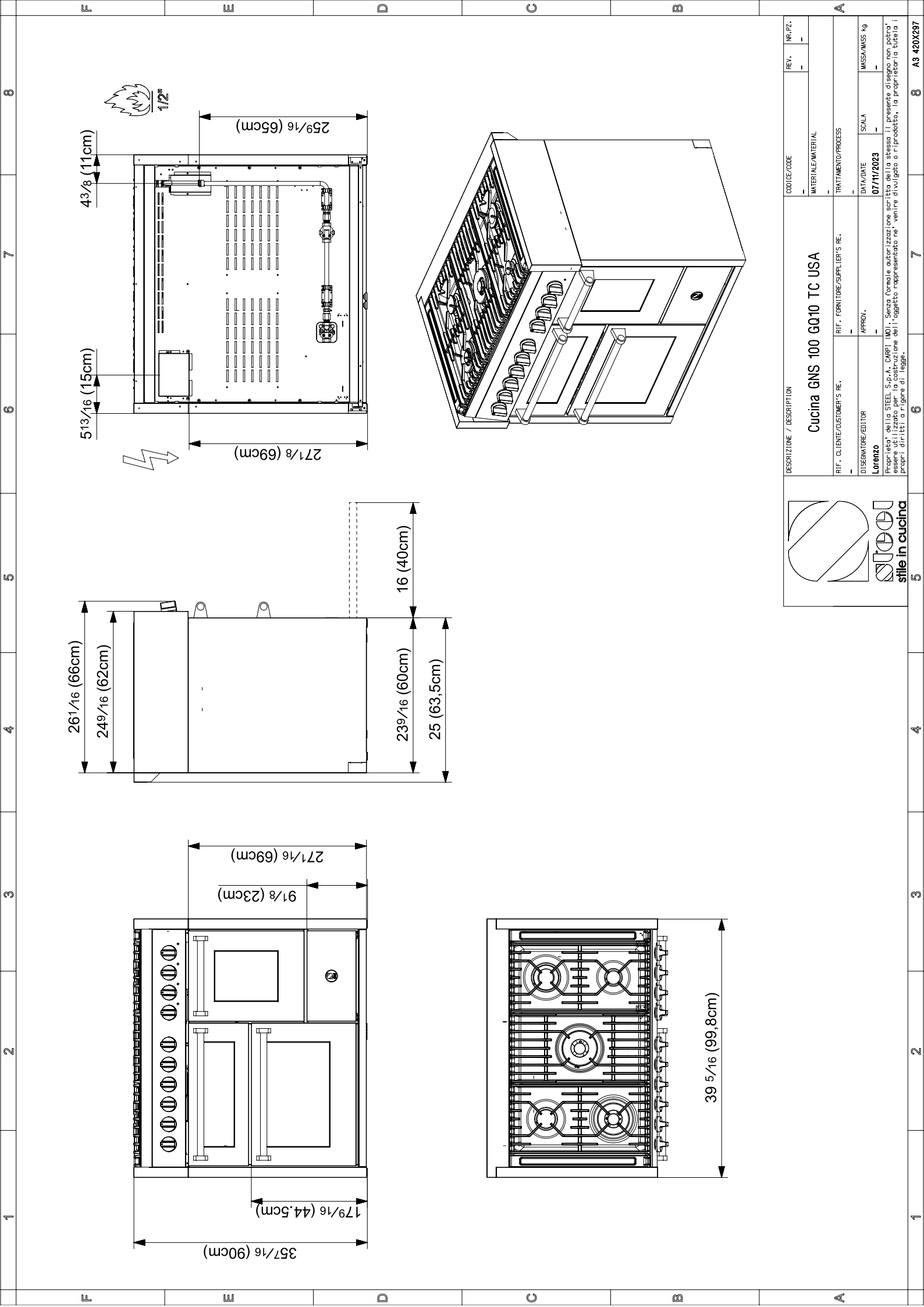

DESCRIZIONE / DESCRIPTION		CODICE/CODE	REV.	NR. PZ.
Cucina GNS 100 GQ10 TC USA		MATERIALE/MATERIAL	-	-
REF. CLIENTE/CUSTOMER'S RE.	REF. FORNITORE/SUPPLIER'S RE.	TRATTAMENTO/PROCESS		
DISSEGNAZIONE/EDITOR	APPROV.	DATA/DATE	SCALA	MASSA/MASS Kg
Lorenzo		07/11/2023		

Proprietà di L.S. STEEL S.p.A. - GARBI (NO) - Senza formula di abbinamento scritto dell'indirizzo di consegna non potrà essere effettuato l'ordine. Per informazioni e istruzioni dell'oggetto rappresentato nel presente disegno o riprodotto, la proprietà è riservata a tutti i diritti di legge.

1 2 3 4 5 6 7 8

A B C D E F

A3 420X297